



**TENNESSEE DEPARTMENT OF ENVIRONMENT AND CONSERVATION  
APPLICATION FOR GROUND WATER PROTECTION SERVICES**

GATE ON  
PROPERTY  
PAGE BEFORE  
GOING OUT

1. SERVICE REQUESTED: (check service)	APPLICANT COMPLETE QUESTIONS:	FEES DUE	PTBMIS CODES V689 Code Supp/Code	
<input type="checkbox"/> Septic System Construction Permit				
<input checked="" type="checkbox"/> Dwelling	2, 3, 4, 7, 8, 9	\$	78064	Yes
<input checked="" type="checkbox"/> Commercial: gpd	2, 3, 4, 7, 8, 9	\$	78064	Yes
<input type="checkbox"/> System Modification	2, 3, 4, 7, 8, 9	\$	78064	Yes
<input type="checkbox"/> Repair	2, 3, 4, 7, 8, 9	\$	78032	
<input type="checkbox"/> Inspection Letter	2, 3, 5, 7, 8, 9	\$	78030	
<input type="checkbox"/> Water Sample				
<input type="checkbox"/> Total Coliform	2, 3, 6, 7, 8, 9	\$	78036	Yes
<input type="checkbox"/> Fecal Coliform	2, 3, 6, 7, 8, 9	\$	78038	Yes
<input type="checkbox"/> Alternative System Permit*		\$	78068	
<input type="checkbox"/> Large Conventional System Plan Review*		\$	78099	
<input type="checkbox"/> Large Alternative System Plan Review*		\$	78099	
<input type="checkbox"/> Experimental System Plan Review*		\$	78072	
<input type="checkbox"/> Subdivision Evaluation: Lots: _____*		\$		
<input type="checkbox"/> Soil Mapping: Type _____ Acres _____*		\$		Yes
<input type="checkbox"/> Installer Permit: Type(s) _____*		\$	78026	Yes
<input type="checkbox"/> Pumper Permit*		\$	78028	
<input type="checkbox"/> Plat Approval — Individual Lot		\$	78029	
<input type="checkbox"/> Domestic Septage Disposal Site Permit		\$	78031	

\*Applicant may review these service requests with Environmental Specialist prior to processing application.

2. **LANDOWNER:**  
 Names: Boyd R. Howard  
 Address: PO Box 824  
MADISONVILLE TN 37354  
 Day Phone: 423-442-1611  
865-564-7593

**APPLICANT**  
 Name: SAME  
 Address: \_\_\_\_\_  
 Day Phone: \_\_\_\_\_

911 address  
**ORIGINAL OWNER**  
 Name: 3621 Malone Rd.

3. **LOCATION OF LOT OR SITE:** a) In a subdivision? \_\_\_\_\_ b) Name: \_\_\_\_\_ Lot # \_\_\_\_\_  
 b) Non-Subdivision  Give specific directions and address to the lot or site: 3621 MALONE RD.

4. **FOR SSDS PERMIT ONLY:** a) Size of lot 34 AC b) Number of Bedrooms \_\_\_\_\_  
 c) How many occupants? 4 Excavated Basement? Yes \_\_\_\_\_ No   
 e) Basement Plumbing Fixtures? Yes  No \_\_\_\_\_  
 f) Amount of water used monthly (gallons) \_\_\_\_\_  
 g) Water Supply: Public \_\_\_\_\_ Well  Spring \_\_\_\_\_  
 h) Is the lot staked? NO YES If not, date it will be staked: \_\_\_\_\_  
 Is the house staked? \_\_\_\_\_ If not, date it will be staked: \_\_\_\_\_  
 i) Installer, if known: HAWK

5. **FOR INSPECTION LETTER ONLY:** Will pick up \_\_\_\_\_ Please mail \_\_\_\_\_  
 a) Age of house \_\_\_\_\_ b) Is house vacant? \_\_\_\_\_ How long? \_\_\_\_\_  
 c) Original sewage system inspected by Health Department? \_\_\_\_\_  
 d) Date of previous repairs \_\_\_\_\_ Inspected \_\_\_\_\_  
 e) Is waste water "backing up" into plumbing fixtures? \_\_\_\_\_ Surfacing or \_\_\_\_\_  
 f) All waste water including washing machines routed into septic tank \_\_\_\_\_

**NAME:** HOWARD, BOYD R  
**SSN** 999999999  
**SEX**  
**YRS** 0 **MON** 0 **DAYS** 0  
**ADDR:** P O BOX 824  
**CITY:** MADISONVILLE **TN** 37354

6. **FOR WATER SAMPLE ONLY:** a) Source of Supply: Spring \_\_\_\_\_ Well \_\_\_\_\_  
 b) Is there an outside faucet? \_\_\_\_\_ c) Is the source chlorinated? \_\_\_\_\_  
 d) For Wells: Is the casing 6" above the ground? \_\_\_\_\_ Is a sanitary seal on the casing? \_\_\_\_\_

7. MAKE A ROUGH SKETCH ON BACK OF THIS **WHITE** PAGE SHOWING DIRECTIONS TO PROPERTY, PROPERTY LINES, HOUSE SITE, WELL LOCATION, SPRING LOCATION, PLANNED DRIVEWAY AND UTILITIES.

8. ALL FEES DUE IN ADVANCE AND ARE NON-REFUNDABLE (except upon appeal). See Fee Schedule on reverse. Make check payable to: **TREASURER, STATE OF TENNESSEE**

9. I certify that the above information is true and correct to the best of my knowledge, and that I have been authorized by the above named landowner to submit this Application for Environmental Services to the Division of Ground Water Protection.

DATE: 1/11/01 SIGNATURE: [Signature] AMOUNT PAID: \$ 100.00 RECEIPT NUMBER 15374

White: File      Canary: Owner

**TENNESSEE DEPARTMENT OF ENVIRONMENT AND CONSERVATION  
DIVISION OF GROUND WATER PROTECTION  
PERMIT FOR CONSTRUCTION OF SUBSURFACE SEWAGE DISPOSAL SYSTEM**

3021

Issued to: <u>HOWARD BOYD</u> Owner, Developer, Contractor, Installer, Etc.	Evaluation Based Upon: <input type="checkbox"/> 1. Soil typing by Soil Scientist <input type="checkbox"/> a. General <input type="checkbox"/> b. High Intensity <input type="checkbox"/> c. Extra High Intensity <input type="checkbox"/> 2. Soil Percolation Test <input checked="" type="checkbox"/> 3. Environmental Specialist Estimated Absorption Rate: <u>60</u> MPI	Type of System: <input checked="" type="checkbox"/> 1. Conventional <input type="checkbox"/> 2. Low Pressure Pipe <input type="checkbox"/> 3. Mound <input type="checkbox"/> 4. Lagoon <input checked="" type="checkbox"/> 5. Large Diameter Graveless Pipe 10" OR <input type="checkbox"/> a. Sand backfill required <input checked="" type="checkbox"/> 6. Other <u>CHAMBER</u>
Location: <u>3621 MALONE RD</u> <u>LOUON, TN</u>	Approval based upon: Statute No. <u>T.C.A. 68-221-403</u> <input type="checkbox"/> (c) Percolation test <input type="checkbox"/> (d) Grandfather clause. Current standards except those specified <input checked="" type="checkbox"/> (f) 12" (karst) and 6" (non-karst) buffer required	<input type="checkbox"/> (i) 9" buffer required (24"-36" total soil depth) <input type="checkbox"/> (k) Grandfather clause — meets June 30, 1990 standards (repair only) <input type="checkbox"/> Other
Installation: <input checked="" type="checkbox"/> 1. New Installation <input type="checkbox"/> 2. Repair to Existing System Establishment: <input type="checkbox"/> 1. Residential: # Bedrooms <input checked="" type="checkbox"/> 2. Other: <u>4 EMPLOYEE SHOP W/SHOWER</u> (specify) Gal/Day <u>140</u>		

This system shall consist of a two compartment septic tank holding 750 gallons, with 135 linear feet in 2-3 trenches, 36 inches 18"-24" wide and 24-36 inches deep. (Depth of gravel: 12 inches) LOGP

Also required:  
 1. Soil Improvement Practice (SIP)  
 2. Flow Diversion Valve  
 3. Sewage Pump  
 4. Other:

All installers of subsurface sewage disposal systems must hold a valid annual license from the Tennessee Department of Environment and Conservation.

The recipient of this permit agrees to construct or have constructed the above described system in accordance with T.C.A. 68-221-401 et. seq. and The Regulations To Govern Subsurface Sewage Disposal Systems. If any part of the system is covered before being inspected and approved, it shall be uncovered by the recipient of the permit at the direction of personnel of the Department of Environment and Conservation. Any cutting, filling or alterations of the soil conditions on the aforementioned property after this day may render this approval null and void.

X B J R (Signature of Recipient) Date X 1-10-01

Issued at LOUON Tennessee, in LOUON County

By John D. Stone, ESE (Name and Title) Date 01/10/01 (Date of Issue)  
JOHN DAVID STONE

This permit is valid for 3 years from date of issue.

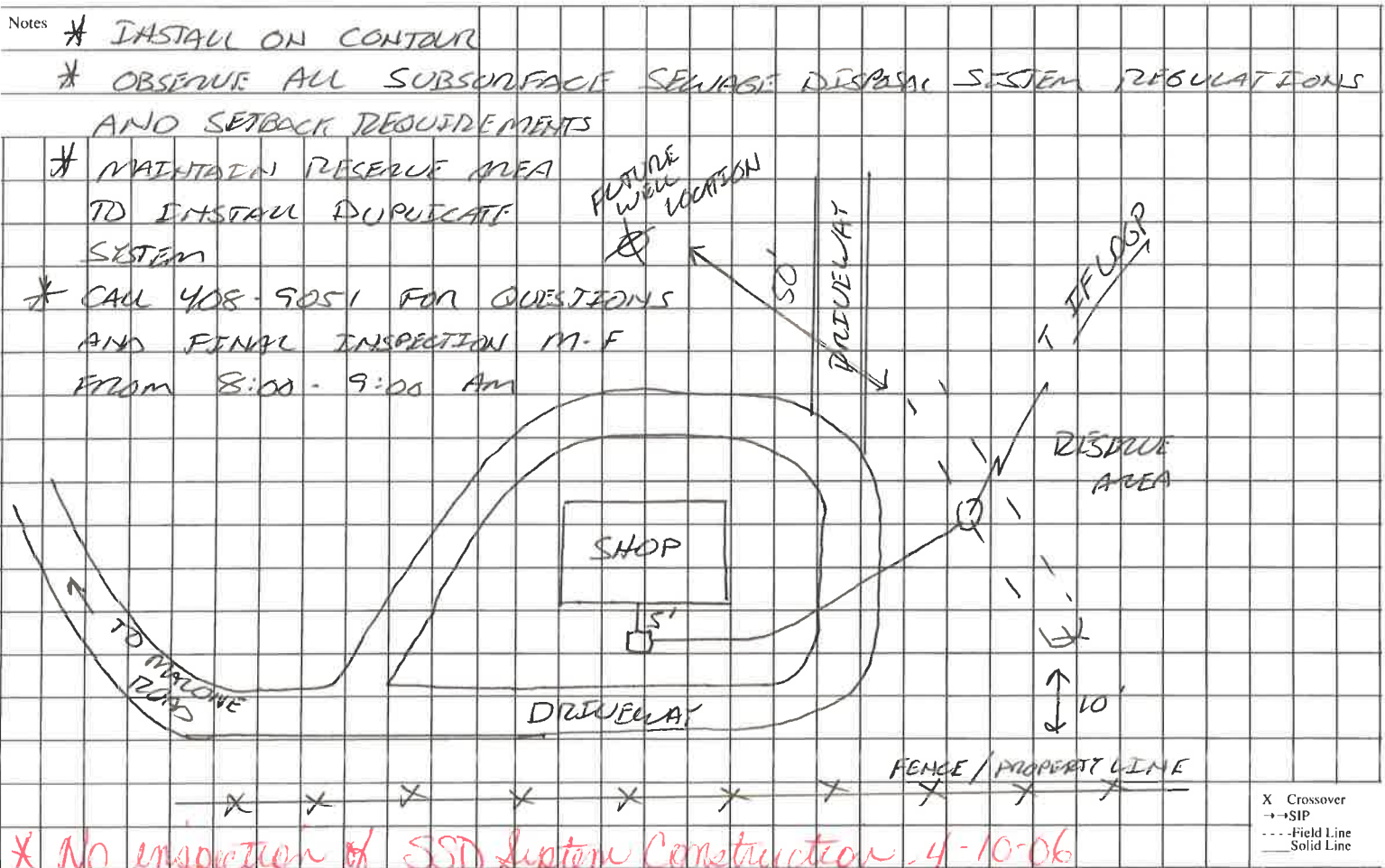

\* No inspection of SSD System Construction - 4-10-06  
V.M.

This is a permit to construct and is not intended to imply approval of any work proposed or completed on this lot.