

Grainger County - Parcel: 094 012.31

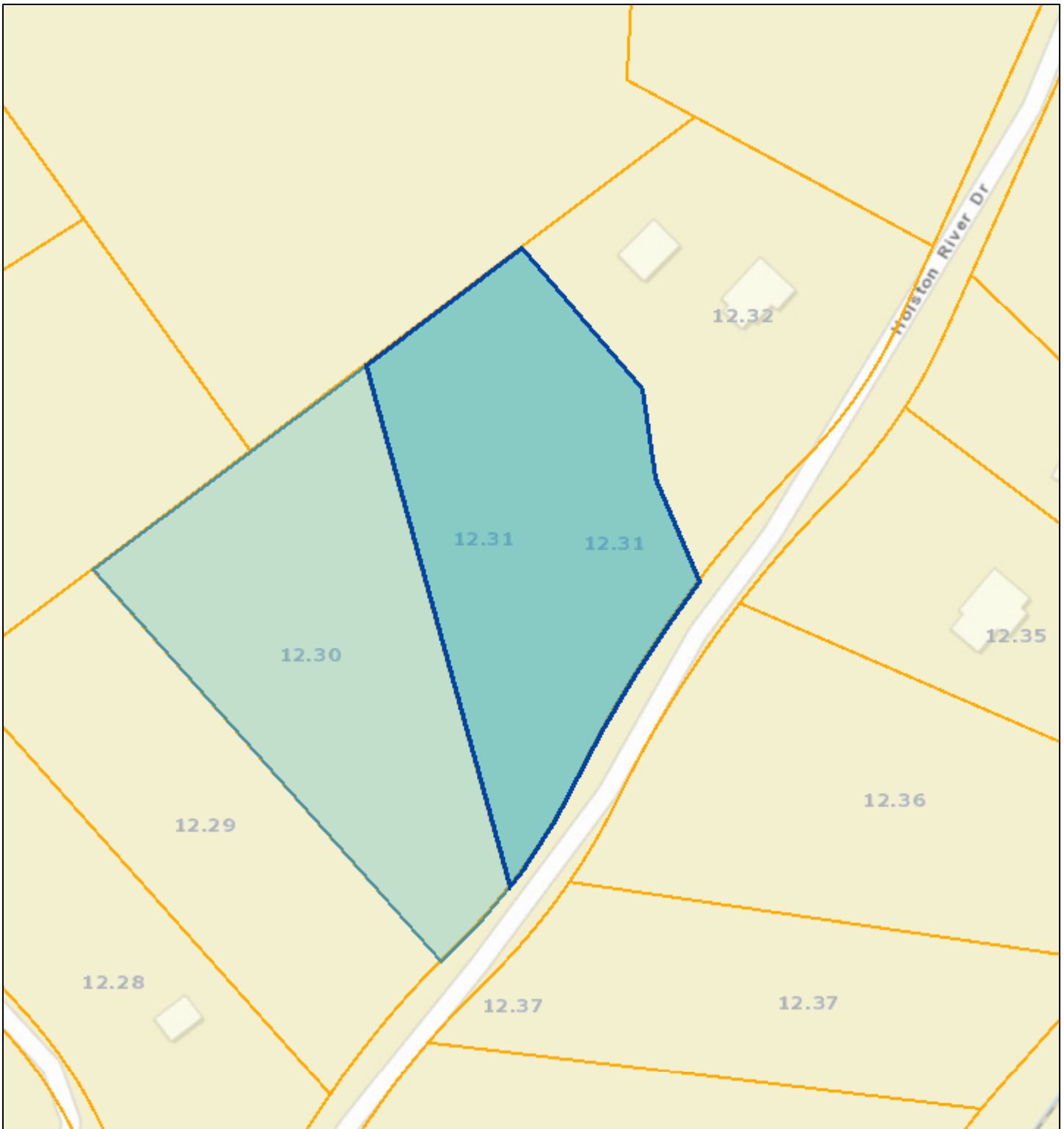

Date: November 11, 2019
County: Grainger
Owner: LEVERING CHARLES & ROBIN
Address: HOLSTON SHORES DR
Parcel Number: 094 012.31
Deeded Acreage: 3.05
Calculated Acreage: 0
Date of Imagery: 2015

Sources: Esri, HERE, Garmin, USGS, Intermap, INCREMENT P, NRCan, Esri Japan, METI, Esri China (Hong Kong), Esri Korea, Esri (Thailand), NGCC, (c) OpenStreetMap contributors, and the GIS User Community
TN Comptroller - OLG
State of Tennessee, Comptroller of the Treasury, Office of Local Government

The property lines are compiled from information maintained by your local county Assessor's office but are not conclusive evidence of property ownership in any court of law.

Grainger County - Parcel: 094 012.30

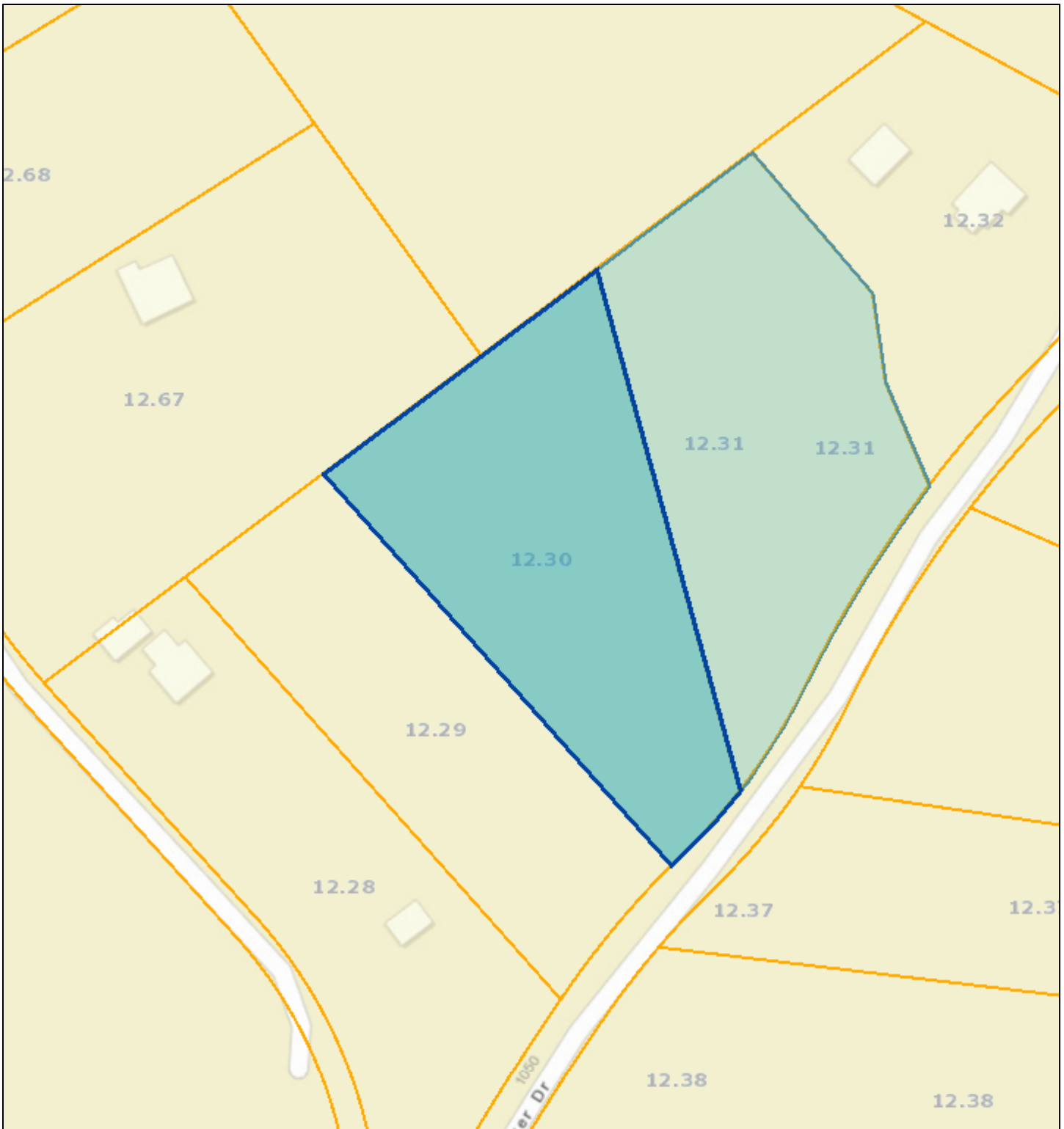

Date: November 11, 2019
County: Grainger
Owner: LEVERING CHARLES & ROBIN
Address: HOLSTON RIVER DR
Parcel Number: 094 012.30
Deeded Acreage: 3.13
Calculated Acreage: 0
Date of Imagery: 2015

Sources: Esri, HERE, Garmin, USGS, Intermap, INCREMENT P, NRCan, Esri Japan, METI, Esri China (Hong Kong), Esri Korea, Esri (Thailand), NGCC, (c) OpenStreetMap contributors, and the GIS User Community
TN Comptroller - OLG
State of Tennessee, Comptroller of the Treasury, Office of Local Government

The property lines are compiled from information maintained by your local county Assessor's office but are not conclusive evidence of property ownership in any court of law.