

Jefferson County - Parcel: 008I E 013.00

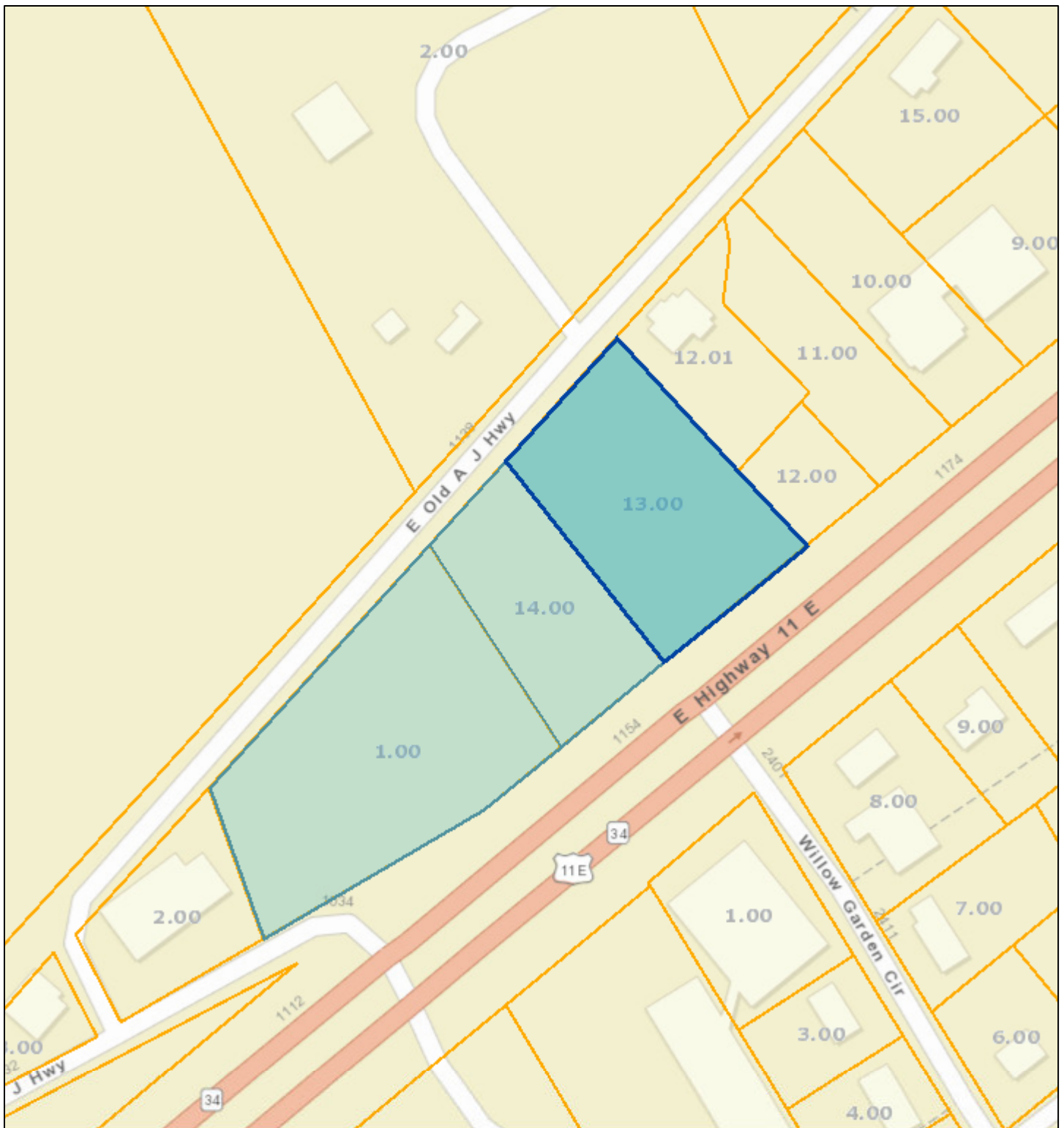

Date: August 22, 2019
County: Jefferson
Owner: MAY STEPHEN DOUGLAS
Address: HWY 11-E E
Parcel Number: 008I E 013.00
Deeded Acreage: 0
Calculated Acreage: 0
Date of Imagery: 2015

Sources: Esri, HERE, Garmin, USGS, Intermap, INCREMENT P, NRCan, Esri Japan, METI, Esri China (Hong Kong), Esri Korea, Esri (Thailand), NGCC, (c) OpenStreetMap contributors, and the GIS User Community
TN Comptroller - OLG
State of Tennessee, Comptroller of the Treasury, Office of Local Government

The property lines are compiled from information maintained by your local county Assessor's office but are not conclusive evidence of property ownership in any court of law.

Jefferson County - Parcel: 008I E 014.00

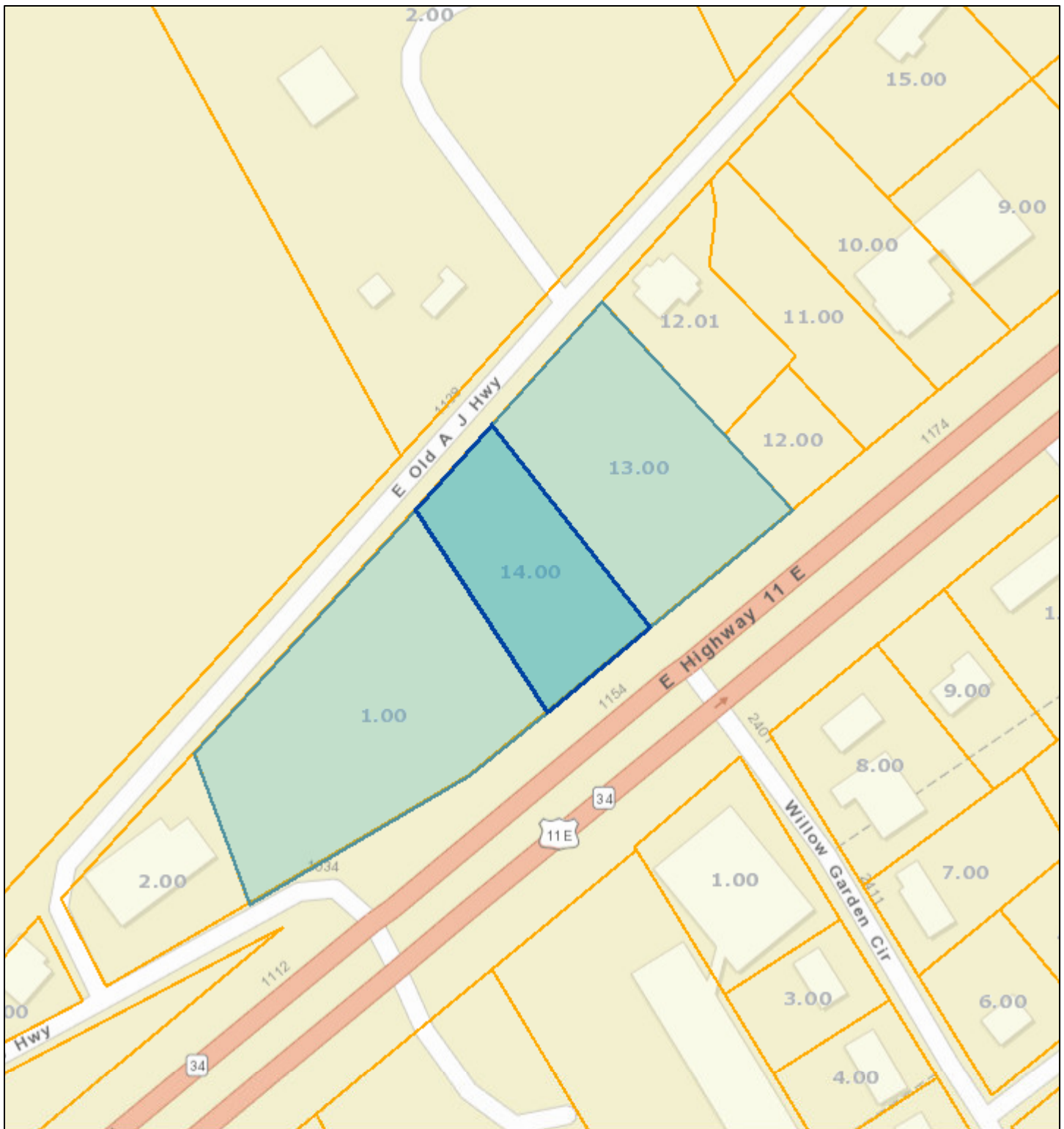

Date: August 22, 2019
County: Jefferson
Owner: MAY STEPHEN DOUGLAS
Address: HWY 11-E E
Parcel Number: 008I E 014.00
Deeded Acreage: 0
Calculated Acreage: 0
Date of Imagery: 2015

Sources: Esri, HERE, Garmin, USGS, Intermap, INCREMENT P, NRCan, Esri Japan, METI, Esri China (Hong Kong), Esri Korea, Esri (Thailand), NGCC, (c) OpenStreetMap contributors, and the GIS User Community
TN Comptroller - OLG
State of Tennessee, Comptroller of the Treasury, Office of Local Government

The property lines are compiled from information maintained by your local county Assessor's office but are not conclusive evidence of property ownership in any court of law.

Jefferson County - Parcel: 015D A 001.00

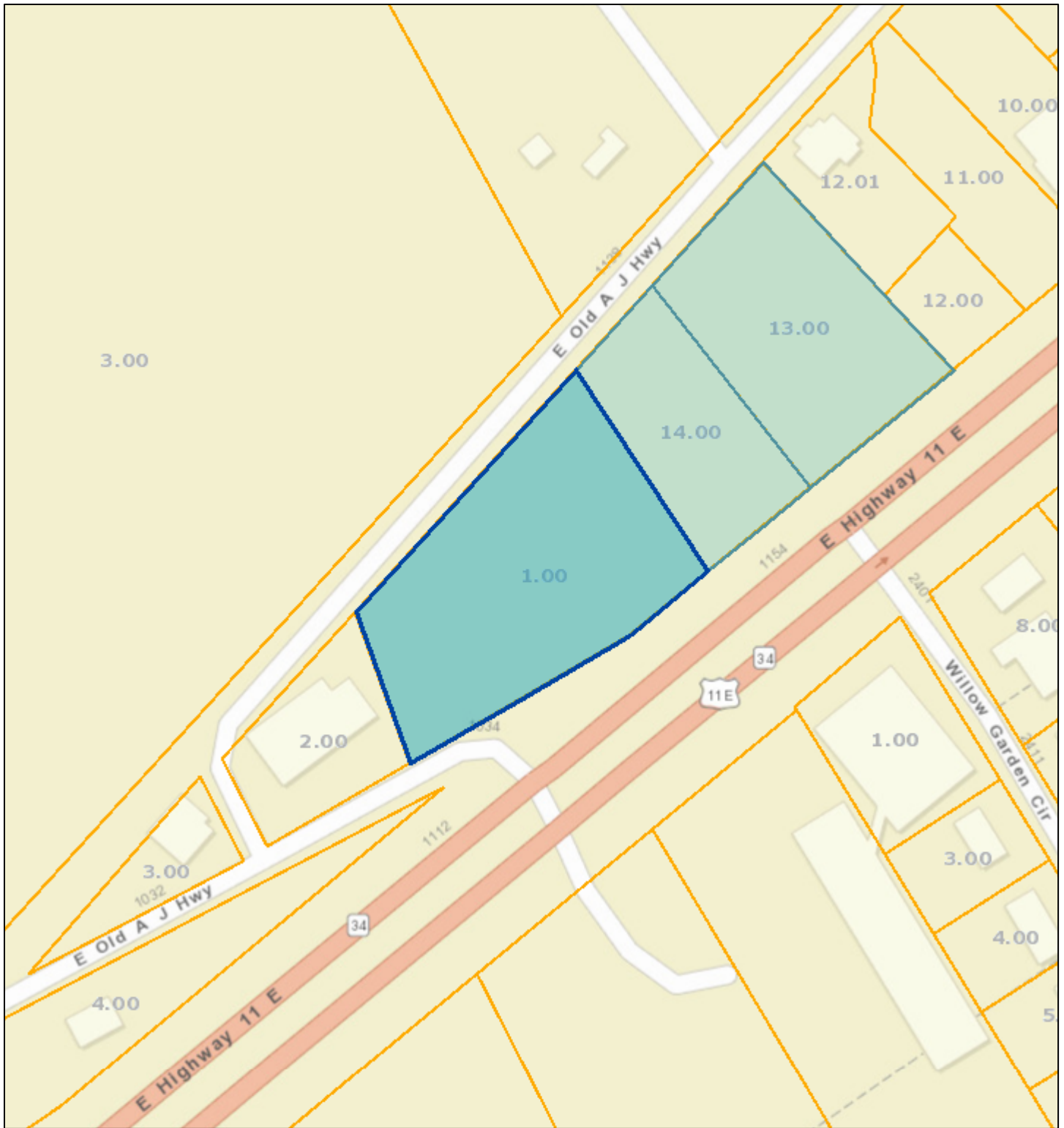

Date: August 22, 2019
County: Jefferson
Owner: MAY STEPHEN DOUGLAS
Address: BROADWAY BLVD E
Parcel Number: 015D A 001.00
Deeded Acreage: 1.95
Calculated Acreage: 0
Date of Imagery: 2015

Sources: Esri, HERE, Garmin, USGS, Intermap, INCREMENT P, NRCan, Esri Japan, METI, Esri China (Hong Kong), Esri Korea, Esri (Thailand), NGCC, (c) OpenStreetMap contributors, and the GIS User Community
TN Comptroller - OLG
State of Tennessee, Comptroller of the Treasury, Office of Local Government

The property lines are compiled from information maintained by your local county Assessor's office but are not conclusive evidence of property ownership in any court of law.